



Product Change Notification

November 30, 2023

Dear Valued Customer,

This notice is to inform you of changes to our EPIC® connectors product line.

Our connectors currently utilize a mix of fixed and removable levers. In an effort to harmonize our EPIC® product line we are converting our fixed lever connectors to a removable lever version. The removable lever is a proven design that has been in use globally for more than a decade.

There will be no change in form, fit, or function. EPIC® connectors will retain their same intermateability. There are several advantages of the removable lever. It utilizes a spring loaded mechanism that provides smooth locking and tactile feedback. Removable levers are replaceable in the event they are damaged.

FIXED LEVER



REMOVABLE LEVER

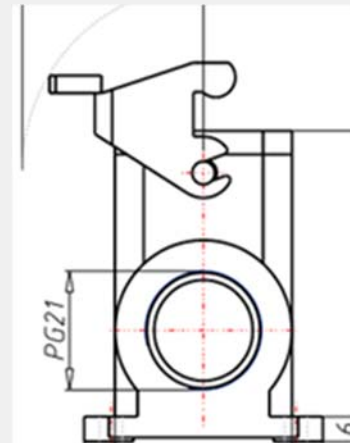

The affected part numbers are listed below:

Discontinued Part Number	Successor Part Number	Discontinued Part Number	Successor Part Number	Discontinued Part Number	Successor Part Number
100050	10005000	700854	70085400	704500	70450000
100070	10007000	700862	70086200	704504	70450400
100060	10006000	700864	70086400	105671	10567100
100090	10009000	701354	70135400	105670	10567000
100140	10014000	701362	70136200	704854	70485400
100240	10024000	701364	70136400	105680	10568000
100340	10034000	101020C0	10102000	104620C0	10462000
100350	10035000	101270	10127000	704740C0	70474000
100320C0	10032000	101170	10117000	105630	10563000
100460	10046000	101370	10137000	704804	70480400
100740	10074000	101380	10138000	104740	10474000
100750	10075000	101320C0	10132000	104741	10474100
700854	70085400	104481	10448100	104821	10482100
700862	70086200	104480	10448000	104720C0	10472000
700864	70086400	104501	10450100	105885	10588500
106338	10633800	104420C0	10442000		
106255C0	10625500	704440C0	70444000		

The below part numbers will be converted to the removable lever, but parts numbers will remain unchanged:

100050NP	100340NP	700854NP	104481NP	104740NP	105880NP	100140NP
100070NP	100350NP	700864NP	104480NP	104741NP	105885NP	701354NP
100060NP	100740NP	101040NP	104501NP	104820NP	101380NP	105680NP
100090NP	100750NP	101050NP	105671NP	701364NP	704854NP	105670NP

Effective date of Implementation:

This change will be fully implemented by February 28, 2024.

Please contact LAPP for any specific need for the old design.

If you have any questions please reach out to the Product Management Team.

Sincerely,

Zachary Howard

Product Specialist

LAPP USA

[Visit our Website](#)

Lapp USA, Inc., 29 Hanover Road, Florham Park, NJ 07932
Tel: 800-774-3539 | Fax: 973-660-9330

A LAPP Company - Lapp Insulator is not affiliated with LAPP