

MECF MATED VIEWS

DO NOT
SCALE FROM
THIS PRINT

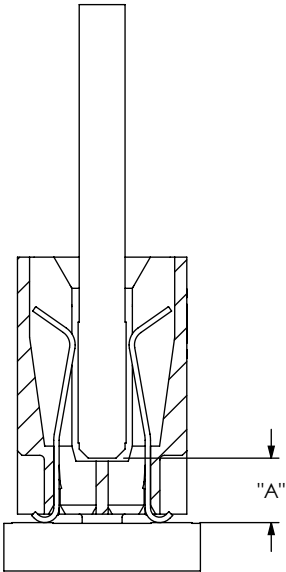

TABLE 1						
	Edge of Card to Board Dimension ("A")	Edge of Card to Connector Edge Dimension ("B")	Max Edge of Card to Board Dimension	Max Edge of Card to Connector Edge Dimension	Min. Contact Wipe	Max. Contact Wipe
FIG 1) MECF	0.088 [2.24]	N/A	Dimension "A" + 0.110 [2.79]	N/A	0.015 [0.38]	0.125 [3.17]

PROPRIETARY NOTE
THIS DOCUMENT CONTAINS INFORMATION
CONFIDENTIAL AND PROPRIETARY TO
SAMTEC, INC. AND SHALL NOT BE REPRODUCED
OR TRANSFERRED TO OTHER DOCUMENTS OR
DISCLOSED TO OTHERS OR USED FOR ANY
PURPOSE OTHER THAN THAT WHICH IT WAS
OBTAINED WITHOUT THE EXPRESSED WRITTEN
CONSENT OF SAMTEC, INC.

samtec
520 PARK EAST BLVD, NEW ALBANY, IN 47150
PHONE: 812-944-6733 FAX: 812-948-5047
e-Mail info@SAMTEC.com code 55322

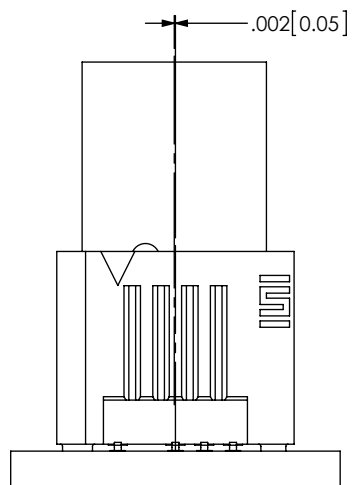

FIG 1
FINAL X AXIS LINEAR MISALIGNMENT

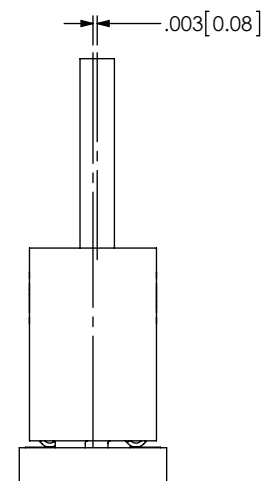

FIG 2
FINAL Y AXIS LINEAR MISALIGNMENT

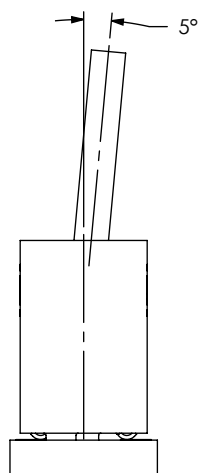

FIG 3
FINAL X AXIS ANGULAR MISALIGNMENT

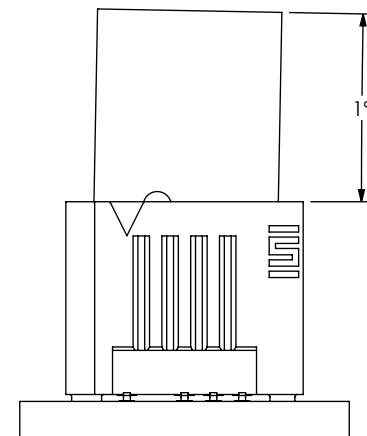

FIG 4
FINAL Y AXIS ANGULAR MISALIGNMENT

NOTES:

1. ALL DIMENSIONS BASED ON NOMINAL VALUES FOR SAMTEC RECOMMENDED PCB LAYOUTS.
2. ALTHOUGH MAX DIMENSIONS ARE LISTED SAMTEC RECOMMENDS FULLY MATING COMPONENTS.
3. MAXIMUM ALLOWABLE ANGLE AT FULLY MATED NOMINAL CONDITIONS.

PROPRIETARY NOTE

THIS DOCUMENT CONTAINS CONFIDENTIAL AND PROPRIETARY INFORMATION AND ALL DESIGN, MANUFACTURING, REPRODUCTION, USE, PATENT RIGHTS AND SALES RIGHTS ARE EXPRESSLY RESERVED BY SAMTEC, INC. THIS DOCUMENT SHALL NOT BE DISCLOSED, IN WHOLE OR PART, TO ANY UNAUTHORIZED PERSON OR ENTITY NOR REPRODUCED, TRANSFERRED OR INCORPORATED IN ANY OTHER PROJECT IN ANY MANNER WITHOUT THE EXPRESS WRITTEN CONSENT OF SAMTEC, INC.

samtec

520 PARK EAST BLVD, NEW ALBANY, IN 47150
PHONE: 812-944-6733 FAX: 812-948-5047
e-Mail: info@SAMTEC.com code 55322